

COMUNE DI:
CASTRIGNANO DEL CAPO



PROVINCIA DI LECCE

Progetto di Variante in corso d'opera mediante alcune modifiche interne di un fabbricato rurale ed un deposito agricolo e realizzazione di una piscina interrata e vano di alloggio dell'impianto idrico di depurazione, il tutto ubicato in località 'francesi' con accesso da via comunale Monticelli tramite stradone privato

z o n a E/1 Fg. 19 P.lle 10-185 e Fg. 4 P.la 92

TAV.2

- INQUADRAMENTO CARTOGRAFICO
- INDICI METRICI

La Committenza: **Sig.ra Rollo Giovanna Pasqualina**_____

n. a San Cesareo di Lecce il 18/11/1960 c.f. RLL GNN 60S58 H793X

Sig. Rossi Carlo_____

n. a Lecce il 02/03/1959 c.f. RSS CRL 59C02 E506T

IL Tecnico:

geom. Francesco Chiffi

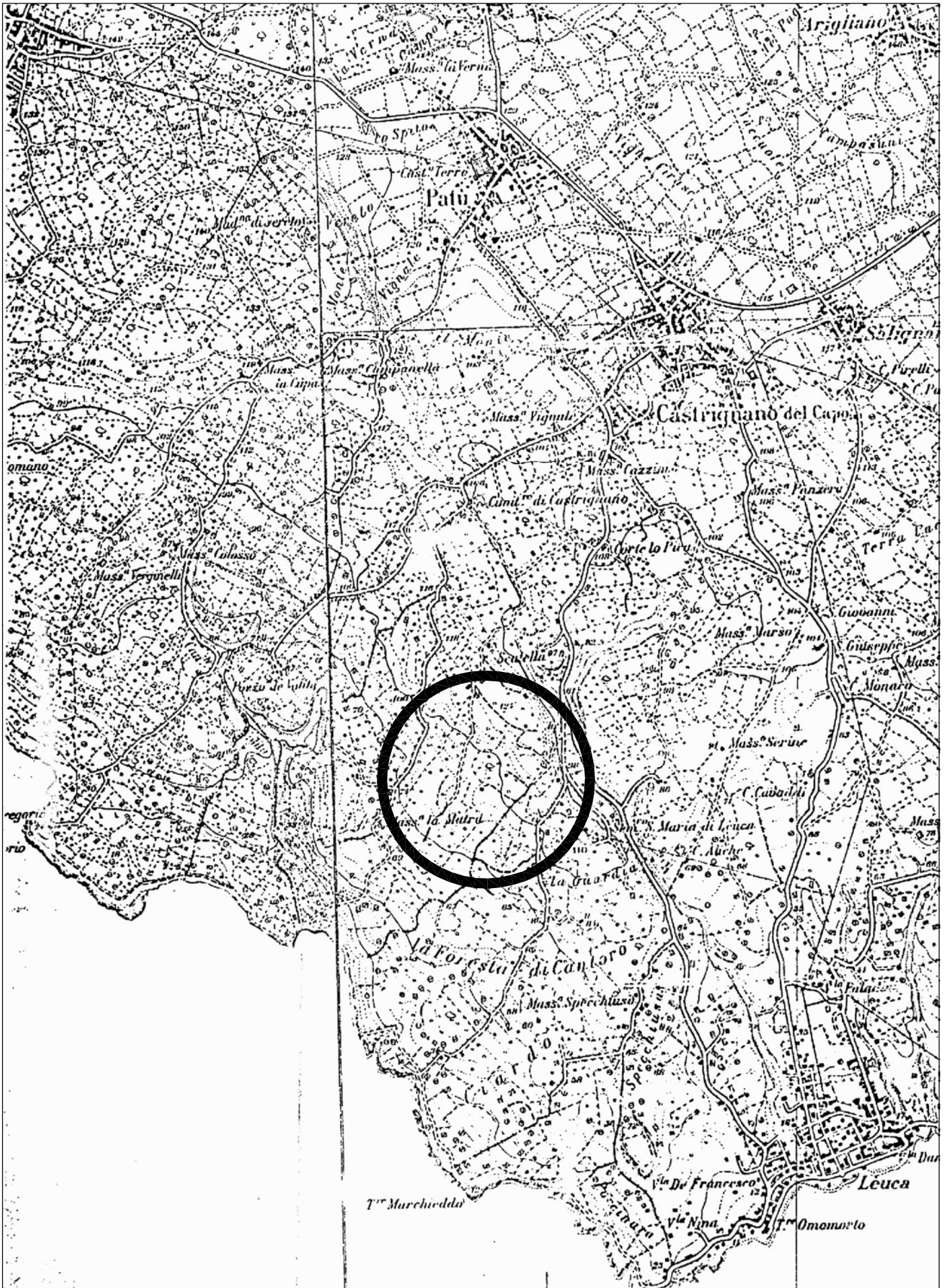

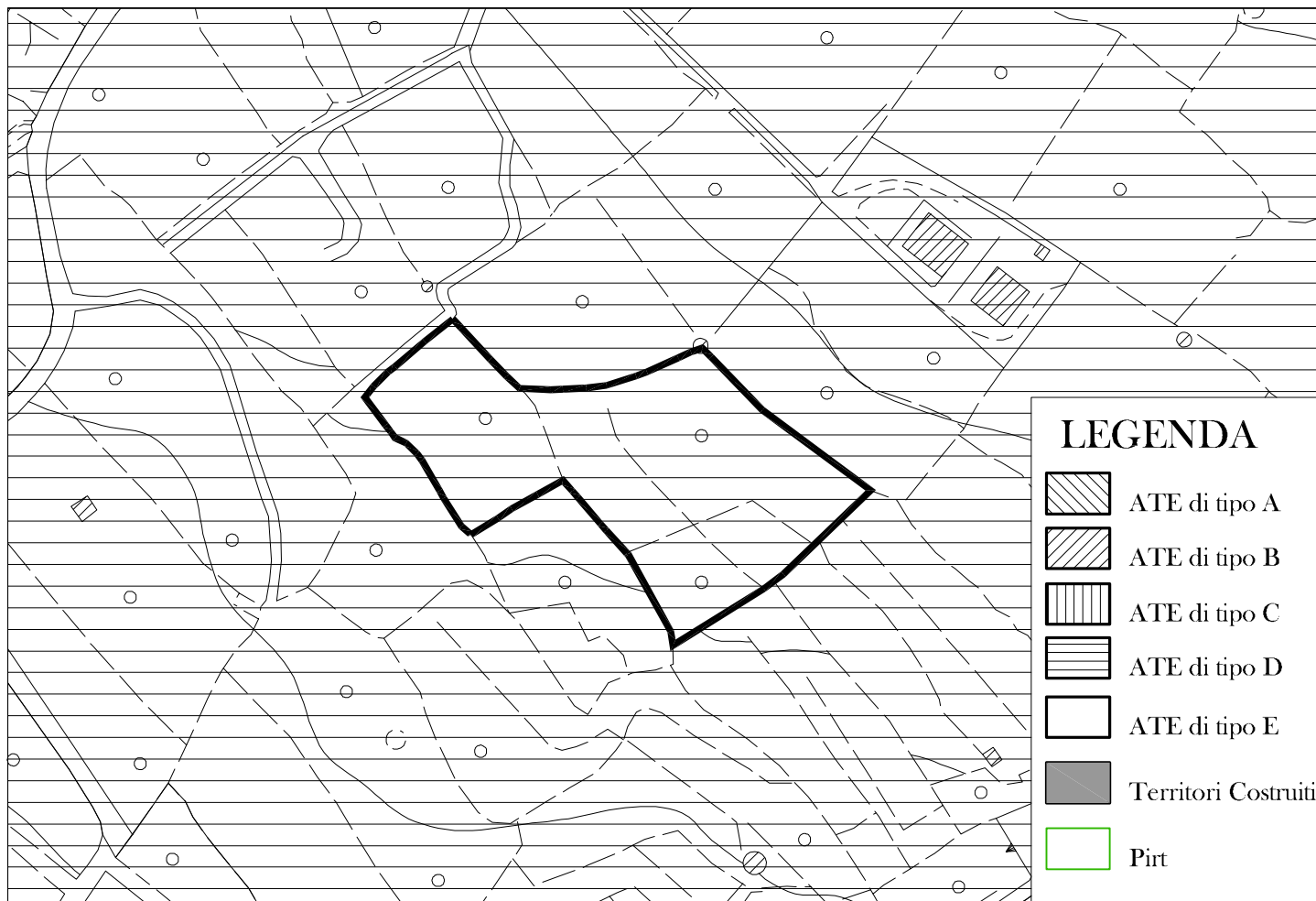

Stralcio di mappa

fig. 19 p.lle 10-185 (lotto di ubicazione)

Scala 1:2000

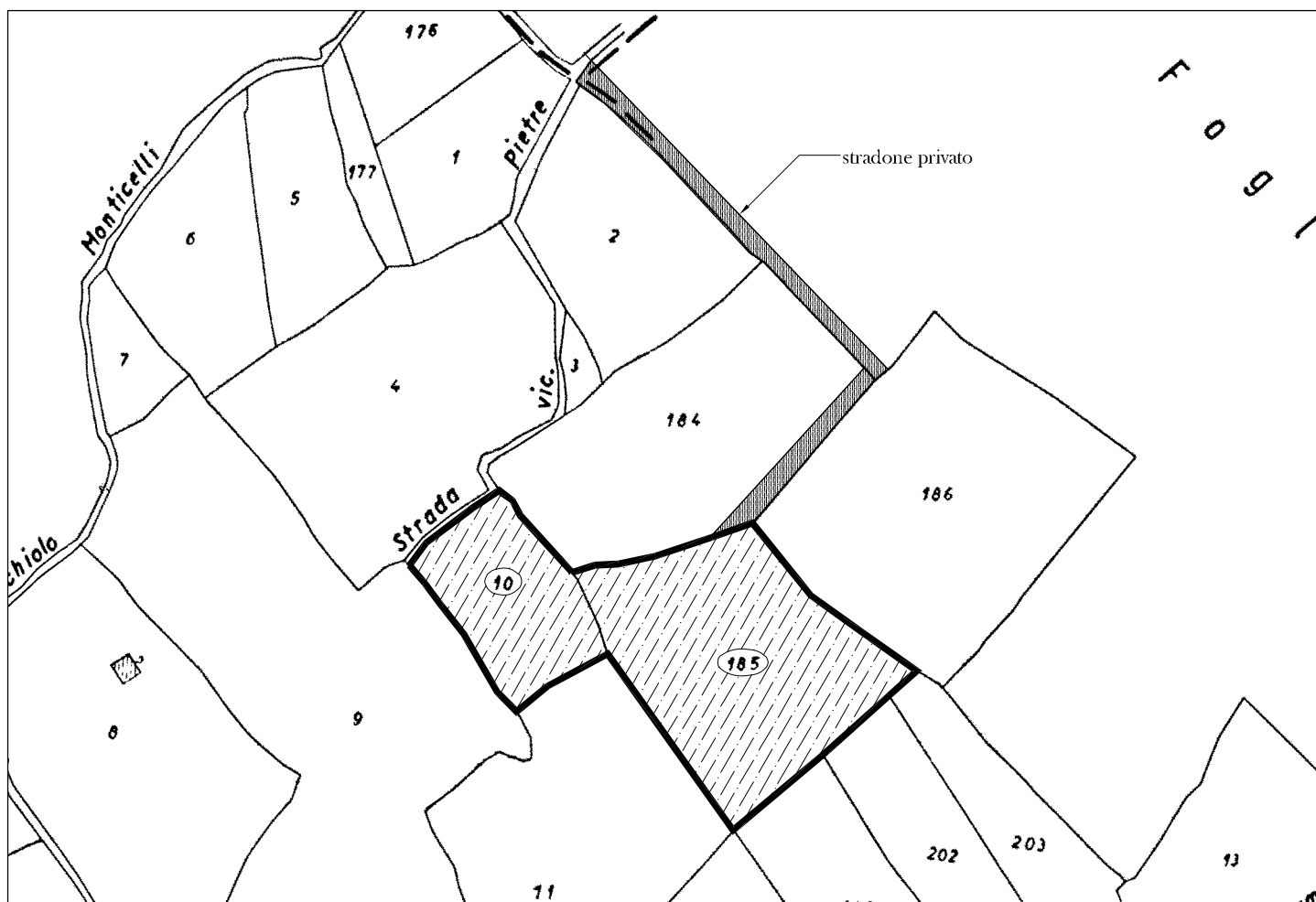

abitazione

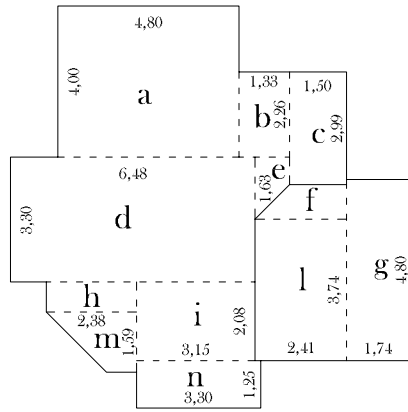

a	=	19.20	mq.
b	=	3.01	mq.
c	=	4.49	mq.
d	=	21.37	mq.
e	=	1.07	mq.
f	=	1.77	mq.
g	=	8.34	mq.
h	=	1.87	mq.
i	=	6.54	mq.
l	=	9.02	mq.
m	=	2.51	mq.
n	=	4.12	mq.
o	=	39.60	mq.

deposito

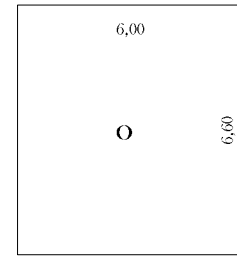

Superficie da realizzare ai fini abitativi

$$a+b+c+d+e+h+i+m+n = 64.18 \text{ mq.}$$

Volume sviluppato (abitazione)

$$64.18 \times 3.00 = 192.54 \text{ mc.}$$

Superficie destinata a garage

$$f+g+l = 18.32 \text{ mq.} < (192.54/10) = 19.25 \text{ mq.}$$

Superficie da realizzare a deposito

$$o = 39.60 \text{ mq.}$$

Volume sviluppato (deposito)

$$39.60 \times 3.00 = 118.80 \text{ mc.}$$

Consistenza dei lotti		
FG. 19 P.lla 185	mq. 4520,00	lotto di ubicazione (unico lotto)
FG. 19 P.lla 10	mq. 1920,00	
FG. 4 P.lla 92	mq. 3970,00	lotto da accorpere

Indici Metrici consentiti in Zona E/1		
Superficie da utilizzare ai fini abitativi		mq.6440,00
Superficie da utilizzare a deposito		mq.3970,00
	in Progetto	Zona E/1
Volume	311.34 mc.	312.30 mc.
Superficie	122.10 mq.	1041.00 mq.
I.F.F.	0.03 mc./mq.	0.03 mc./mq.
R.C.	1.17 %	10 %

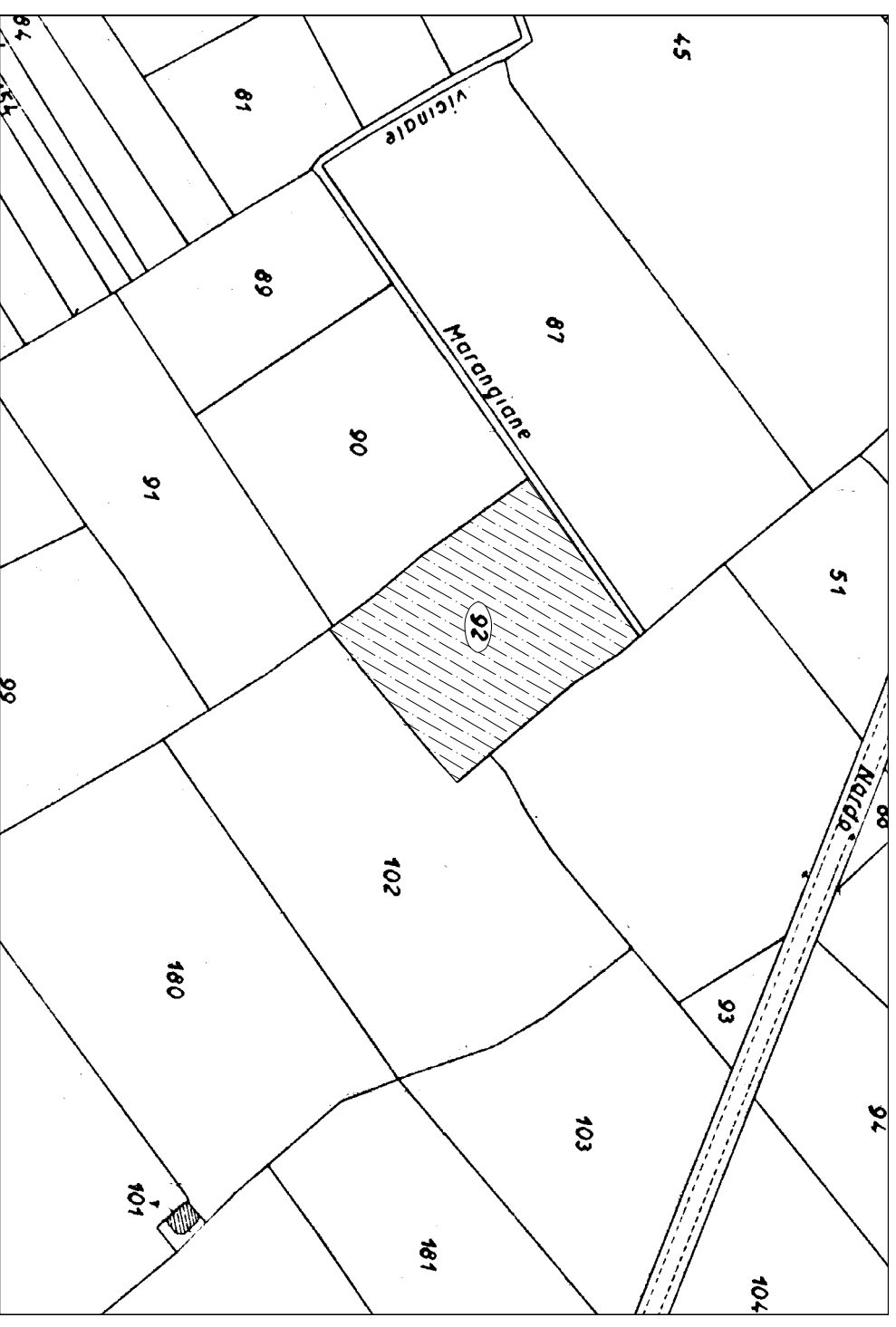

Ubicazione Scala 1:500

(piano quotato)

○ Alberature esistenti

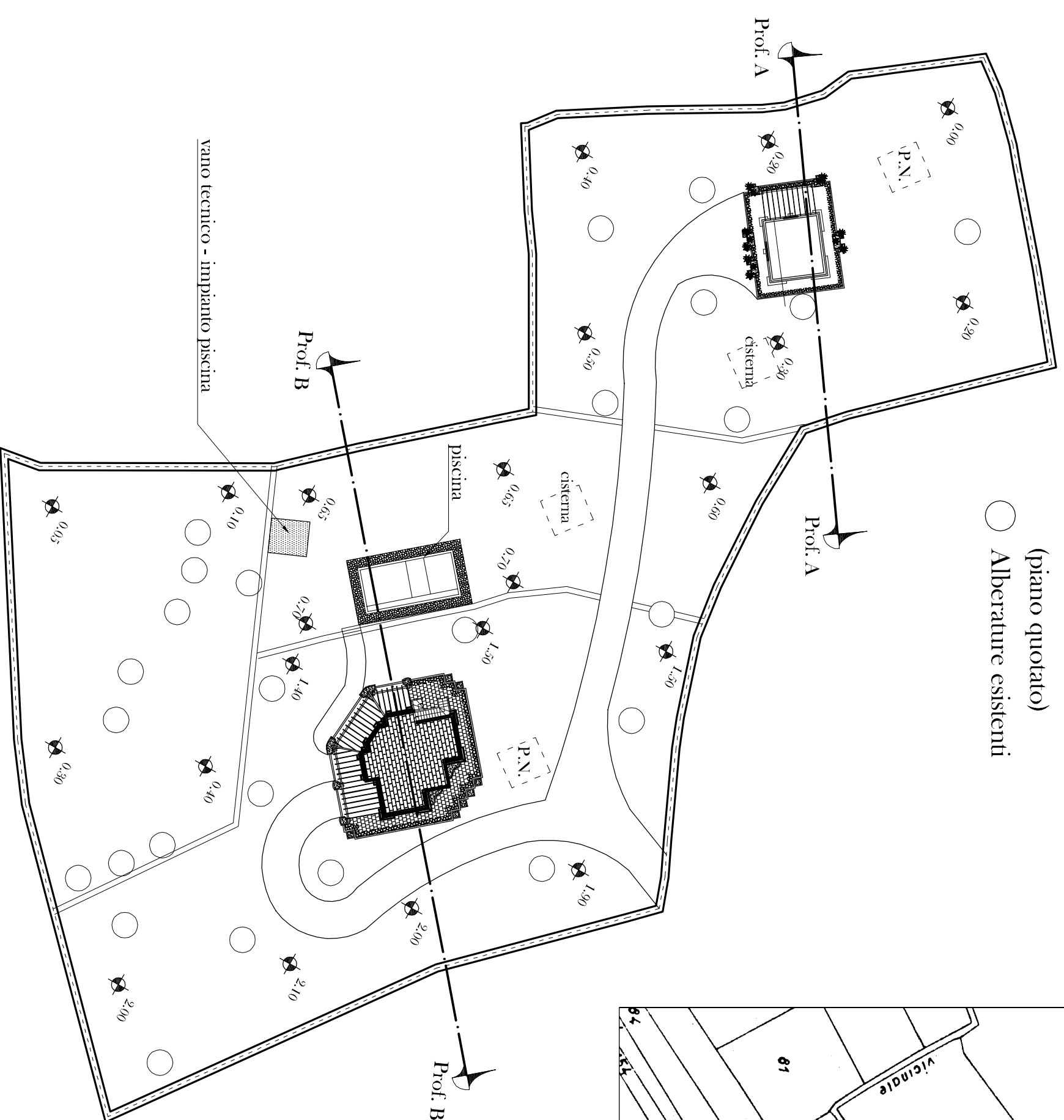

Profilo A~A Scala 1:200

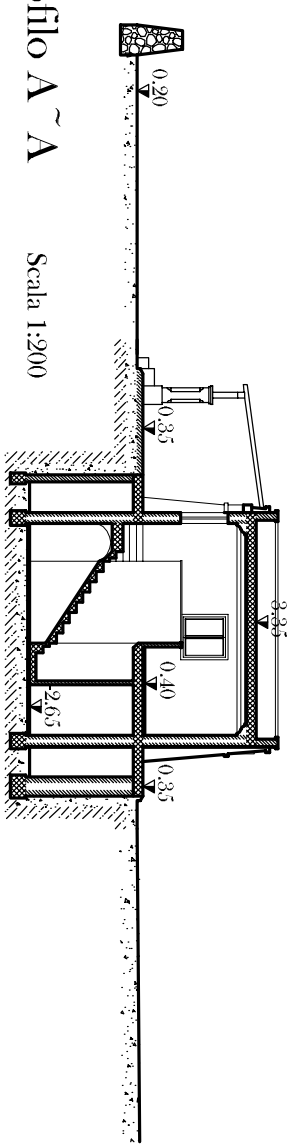

Profilo B~B Scala 1:200

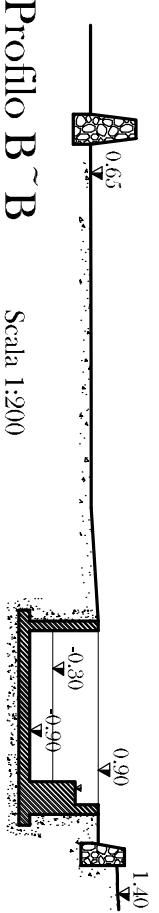

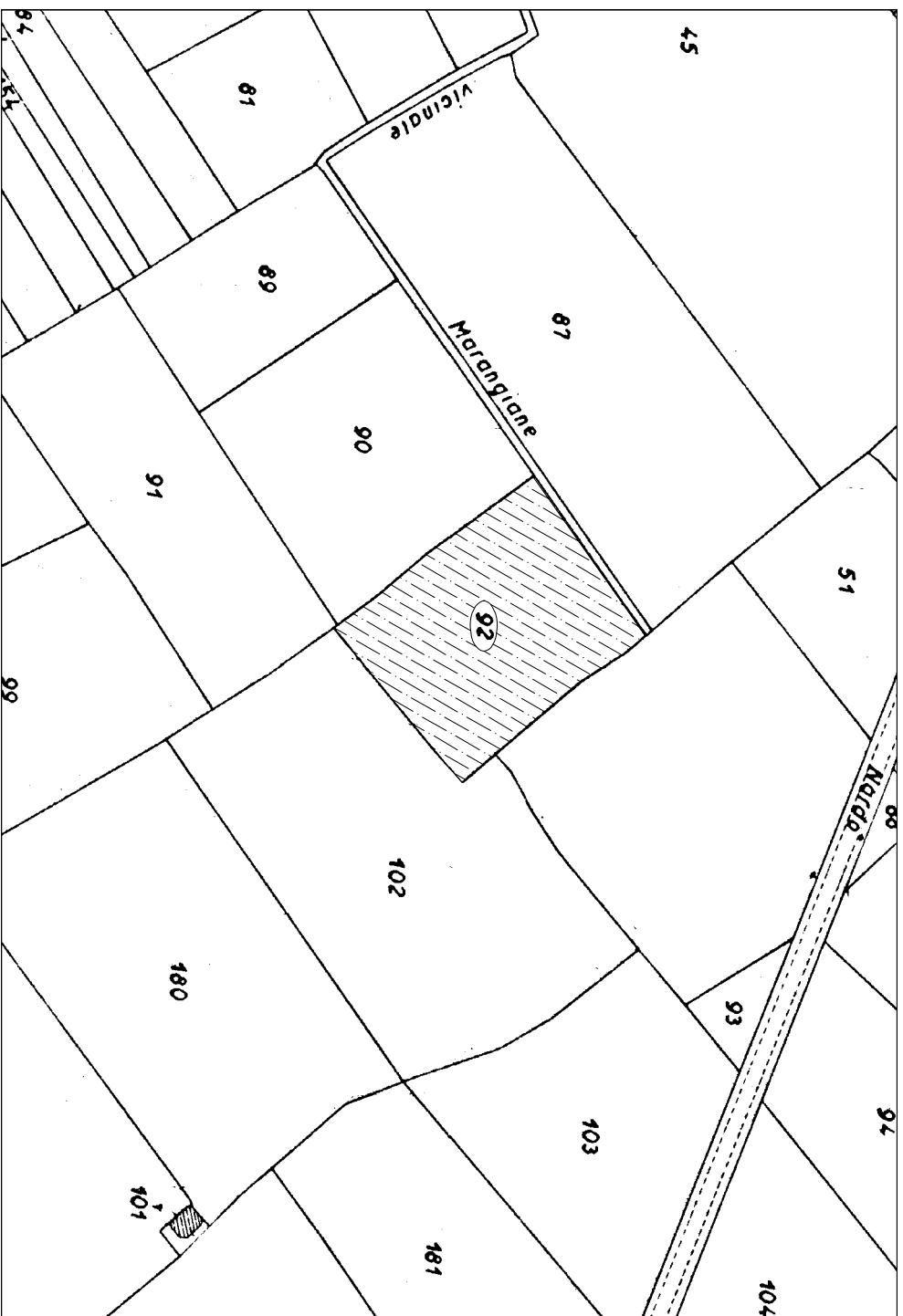

Pianta pozzo nero

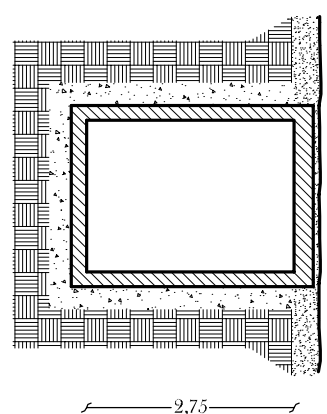
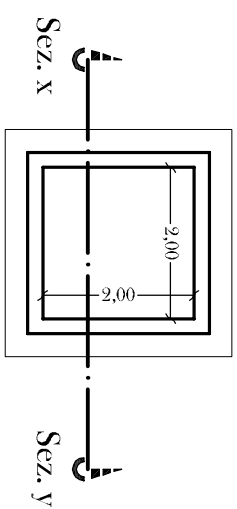

Pianta deposito idrico (cisterna)

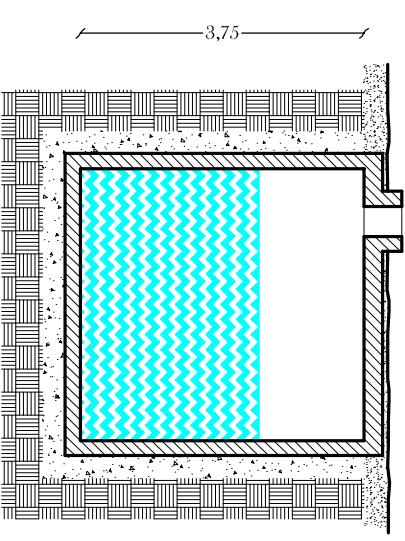
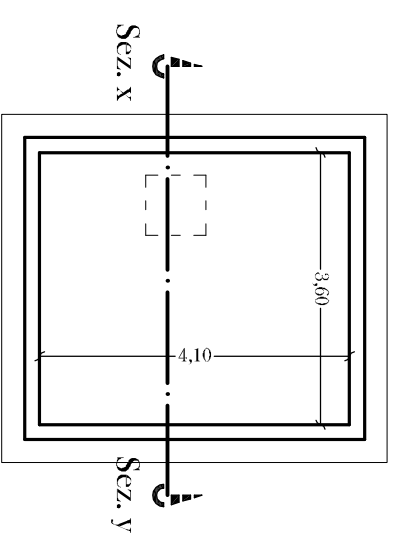

Prof. B

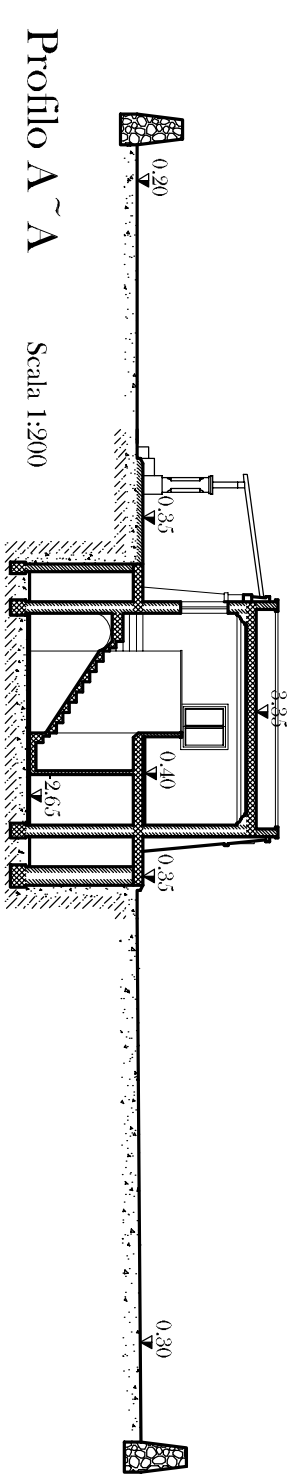

Profilo A~A
Scala 1:200

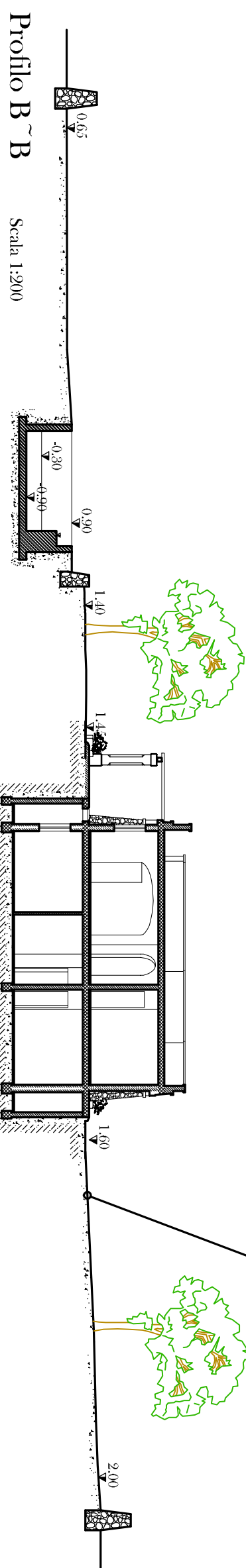
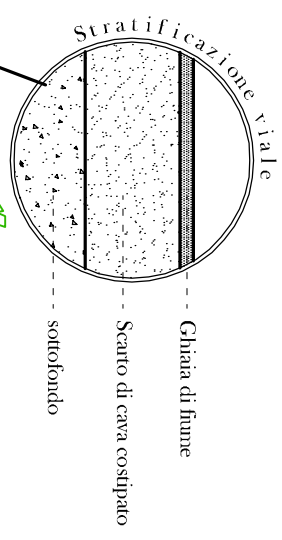

Profilo B~B
Scala 1:200